



# Flat Pack Assembly Instructions

Intubation Shield



Unit Fully Assembled





Component list

Component	#
1. Side Panel	2
2. Diagonal Panel	1
3. Top Panel	1
4. Back Panel	1
5. Front Panel	1
6. Side Clamp	2
7. Front Upper Clamp	2
8. Front Lower Clamp	2
9. Curtain Clamp	1
10. Access Hole Clamp	1

Component	#
11. Back Curtain	1
12. Access hole Insert	1
13. Large Front Port Inserts	4
14. Small Side Port Inserts	4
15. 90° Bracket	21
16. 120° Bracket	3
17. 150° Bracket	3

Fixings	#	Tools	# (min*)
18. M4 x 16 button head Bolts	48	22. 2.5mm Allen (hex) key	1
20. M4 x 10 button head Bolts	50	23. 7mm Spanner	1
20. M4 Dome head nuts	98		
21. Sealant or adhesive	n/a		

*\* Dependant on number of operators*



Component	#	Size
1. Side Panel	2	620mm x 600mm
2. Diagonal Panel	1	642mm x 492mm
3. Top Panel	1	642mm x 190mm
4. Back Panel	1	642mm x 366mm
5. Front Panel	1	642mm x 360mm
6. Side Clamp	2	256mm x 256mm
7. Front Upper Clamp	2	213mm x 151mm
8. Front Lower Clamp	2	213mm x 207mm
9. Curtain Clamp	1	632mm x 38mm
10. Access Hole Clamp	1	85mm x 60mm

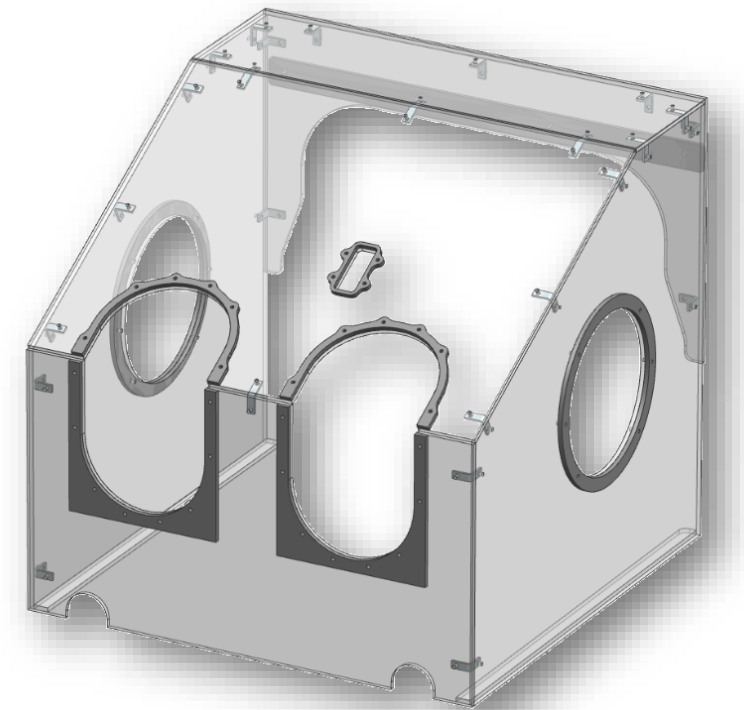

Covers	#	Size
11. Back Curtain	1	600mm x 600mm
12. Access hole Insert	1	85mm x 60mm
13. Large Front Port Inserts	4	360mm x 212mm
14. Small Side Port Inserts	4	256mm x 140mm

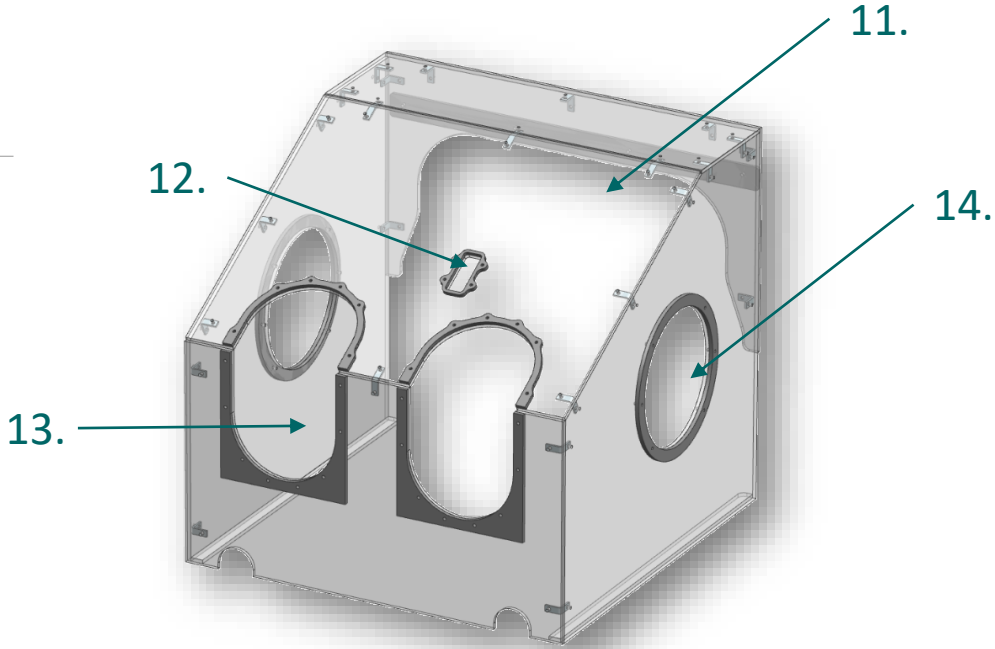

11.



13.

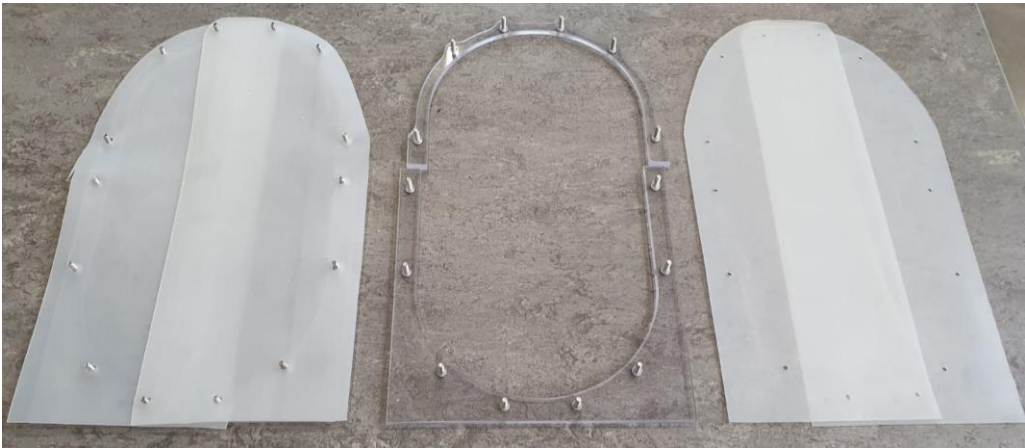

14.



12.



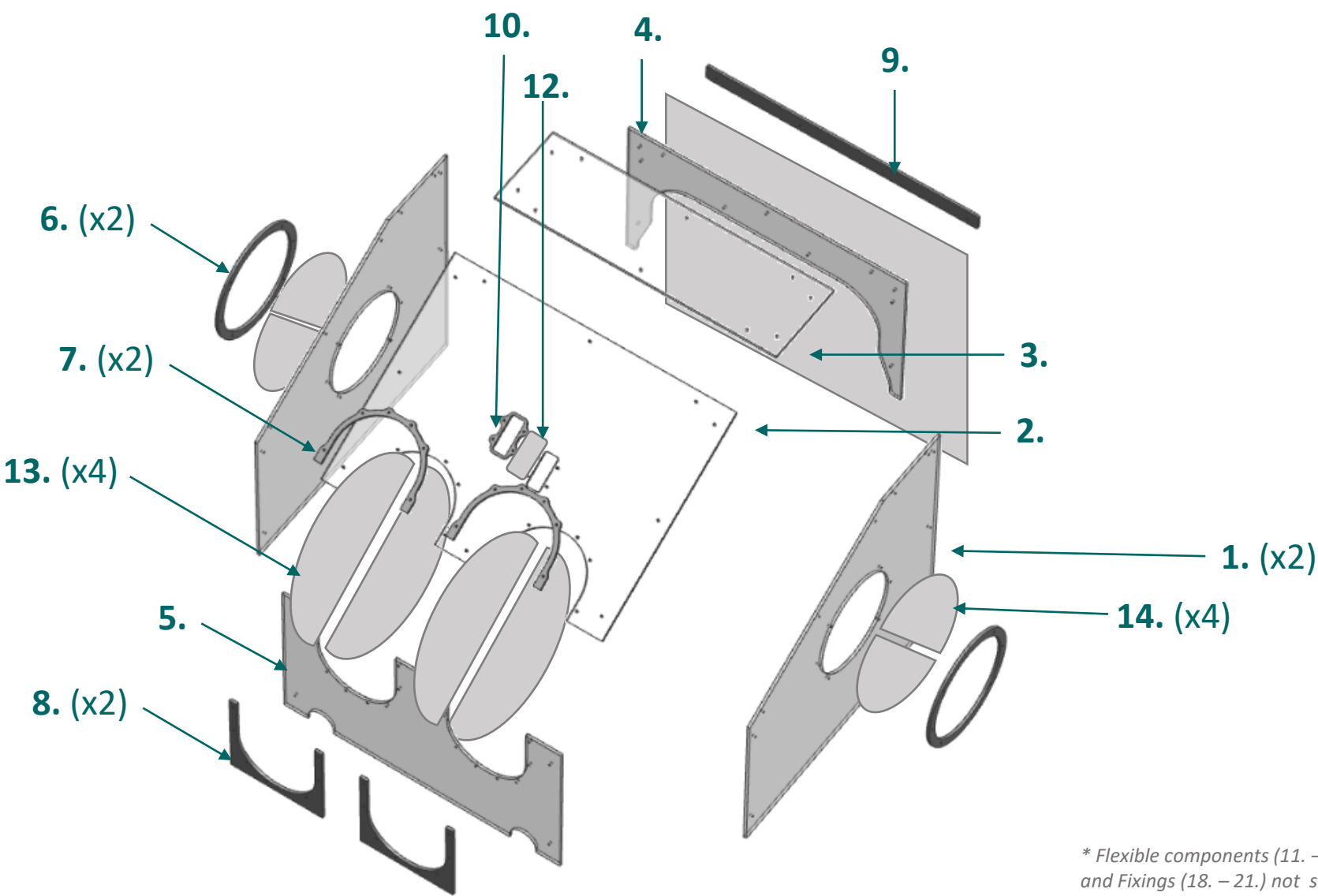

*\* Flexible components (11. – 14.), Brackets (15. – 17. ) and Fixings (18. – 21.) not shown for clarity*



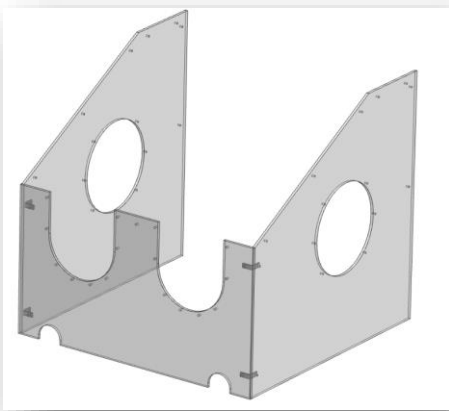
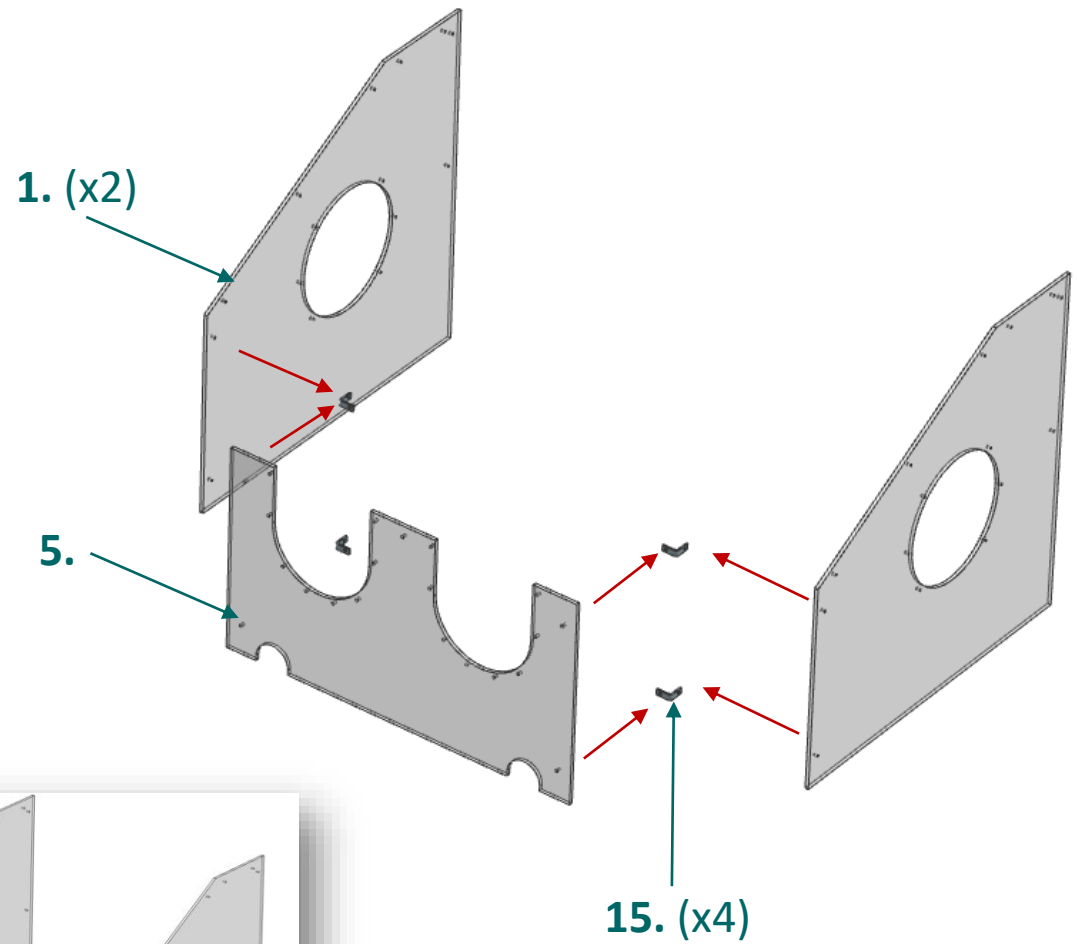

Component		#
1.	Side Panel	2
5.	Front Panel	1
15.	90° Bracket	4
19.	M4 x 10 button head Bolts	8
20.	M4 Dome Nuts	8

- Mount the brackets to the inside of the front panel in 4 places loosely with listed fixings, nuts on the inside
- Align 1<sup>st</sup> side panel and attach, torque all bolts on that side to 1Nm or as tight as able without exceeding this value
- Repeat with the 2<sup>nd</sup> side panel

*\* Fixings (19. – 20.) not shown for clarity*

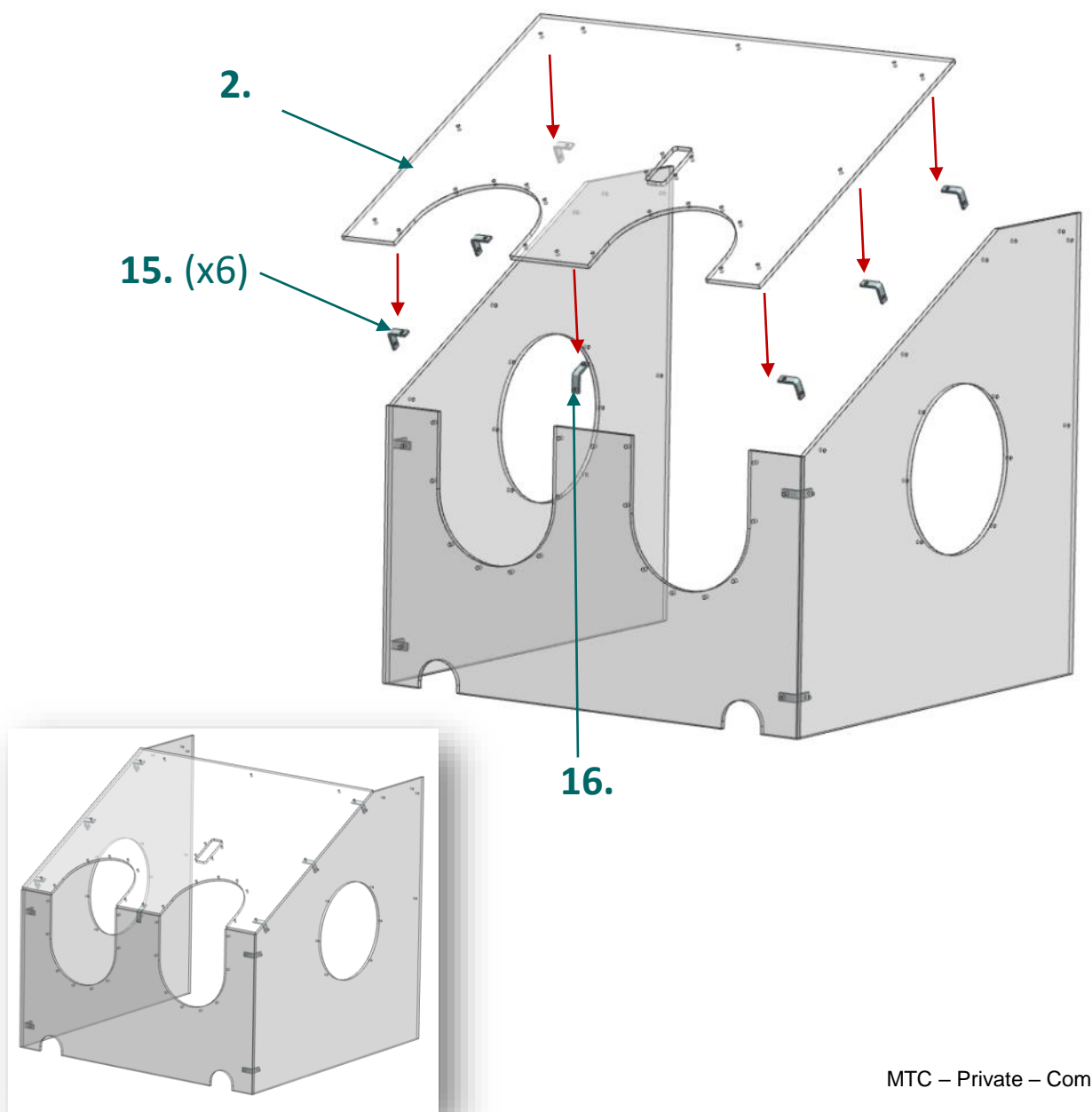

Component	#
Assembly (Step 1)	1
2. Diagonal Panel	1
15. 90° Bracket	6
16. 120° Bracket	1
19. M4 x 10 button head Bolts	14
20. M4 Dome Nuts	14

- Mount the 90° brackets to the inside of the side panels (assembly) loosely in 6 places with listed fixings, nuts on the inside
- Mount the 120° bracket loosely in the central fixing hole on the front panel (assembly) with listed fixings, nuts on the inside
- Align the Diagonal panel and attach, torque all bolts on that side to 1Nm or as tight as able without exceeding this value

*\* Fixings (19. – 20.) not shown for clarity*

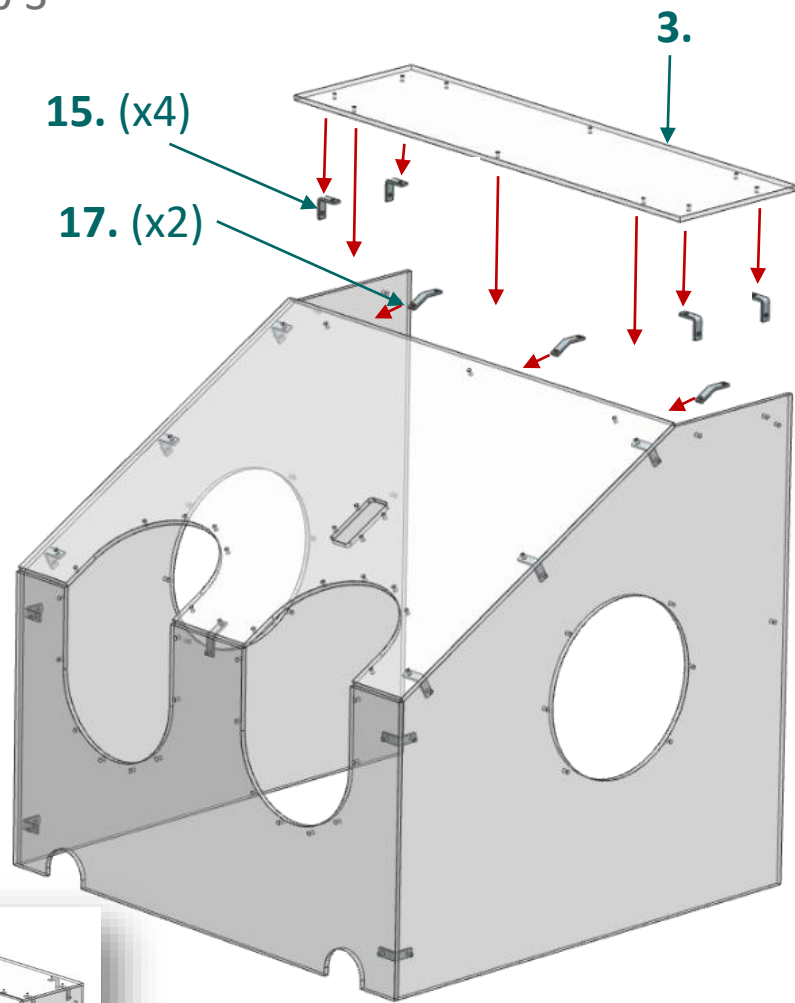

Component		#
Assembly (Step 3)		1
3.	Top Panel	1
15.	90° Bracket	4
17.	150° Bracket	3
19.	M4 x 10 button head Bolts	14
20.	M4 Dome Nuts	14

- Mount the 150° brackets to the inside of the diagonal panel (assembly) loosely in 3 places with listed fixings, nuts on the inside
- Mount the 90° brackets to the inside of the side panels (assembly) loosely in 4 places with listed fixings, nuts on the inside
- Align the top panel and attach, torque all bolts on that side to 1Nm or as tight as able without exceeding this value

*\* Fixings (19. – 20.) not shown for clarity*

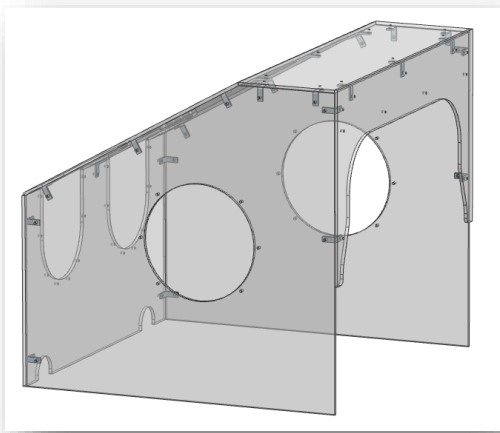
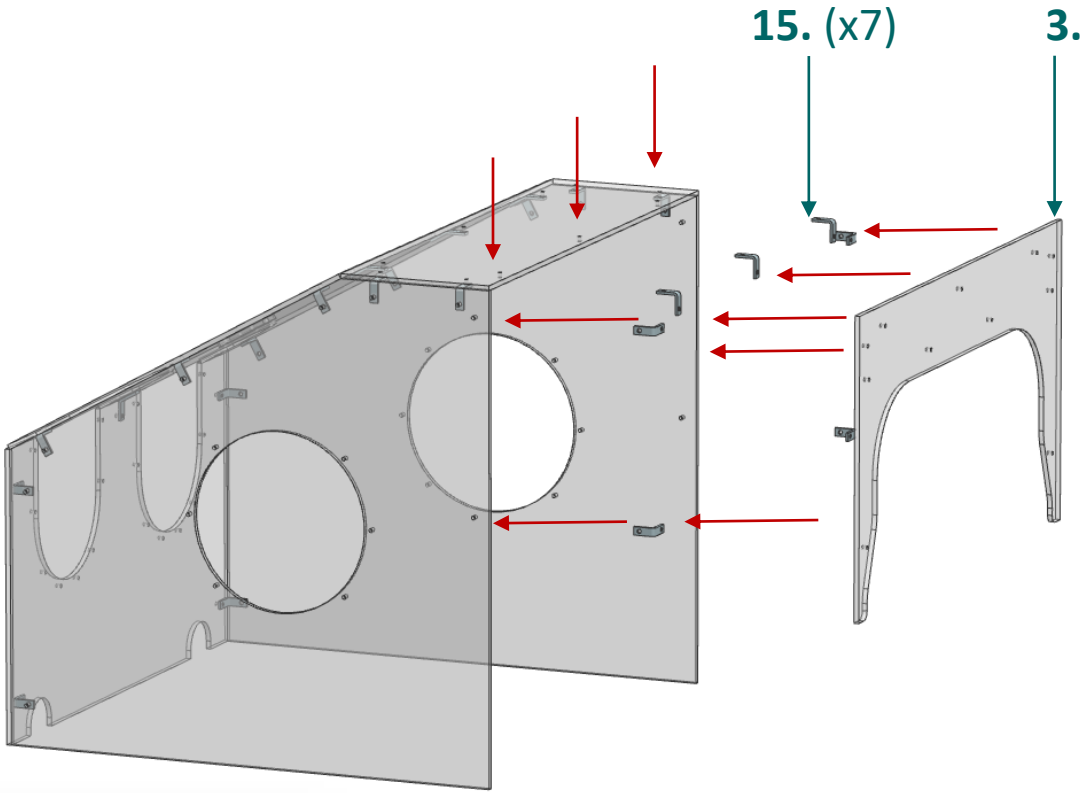

Component	#
Assembly (Step 4)	1
3. Back Panel	1
15. 90° Bracket	7
19. M4 x 10 button head Bolts	14
20. M4 Dome Nuts	14

- Mount 3 of 90° brackets to the inside of the back panel loosely with listed fixings, M4 nuts on the inside
- Mount 3 90° brackets to each side panel (assembly) loosely with listed fixings, M4 nuts on the inside
- Align the back panel with the assembly and attach, the side port holes may need to be used to access and tighten
- Torque all bolts on that side to 1Nm or as tight as able without exceeding this value

\* Fixings (19. – 20.) not shown for clarity

Component	#
Assembly (Step 5)	1
21. Sealant	n/a

- Once the full box is assembled run sealant along the bolted edges
- Sealant depicted by -----

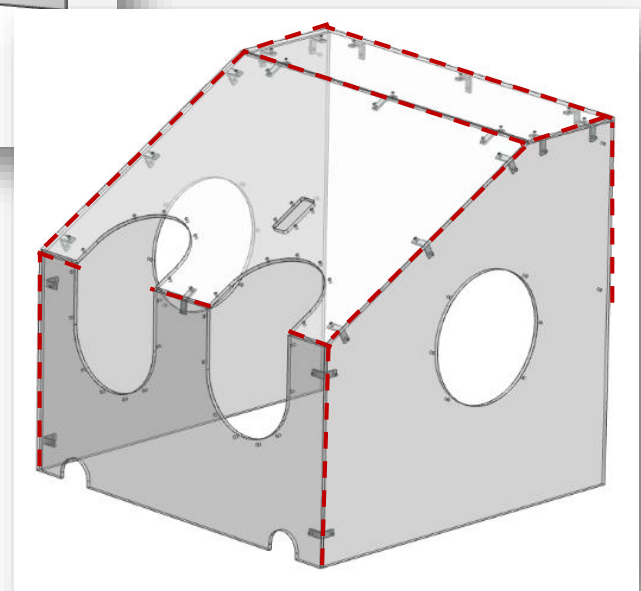
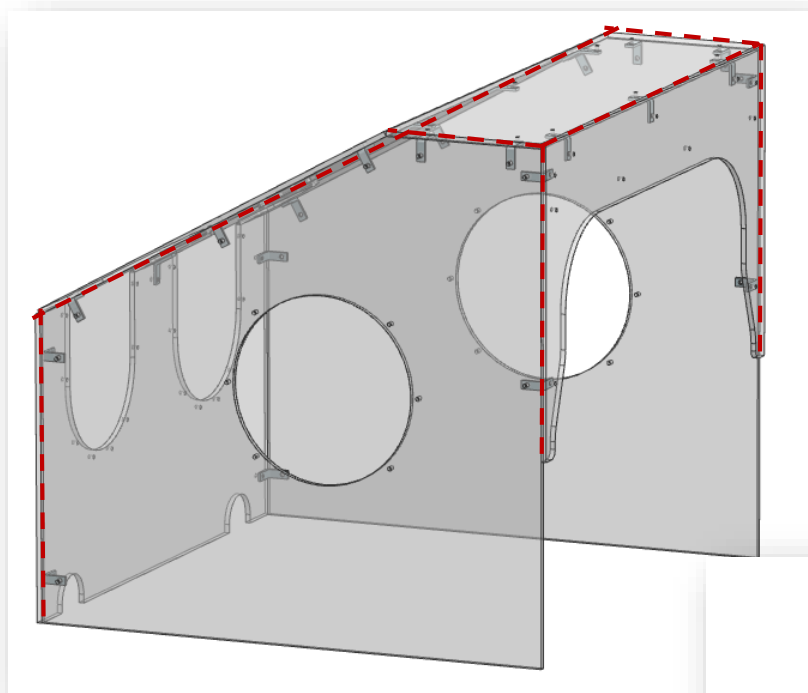

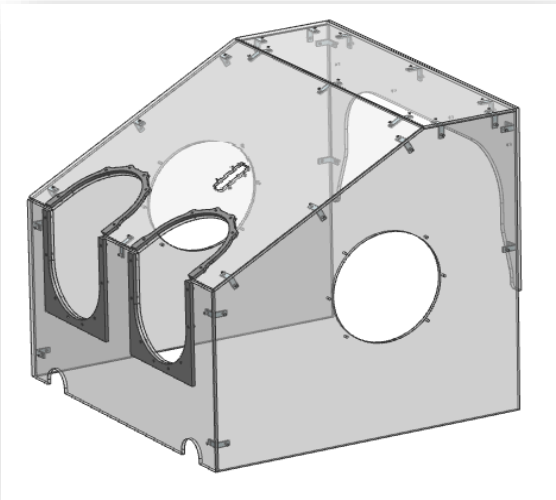
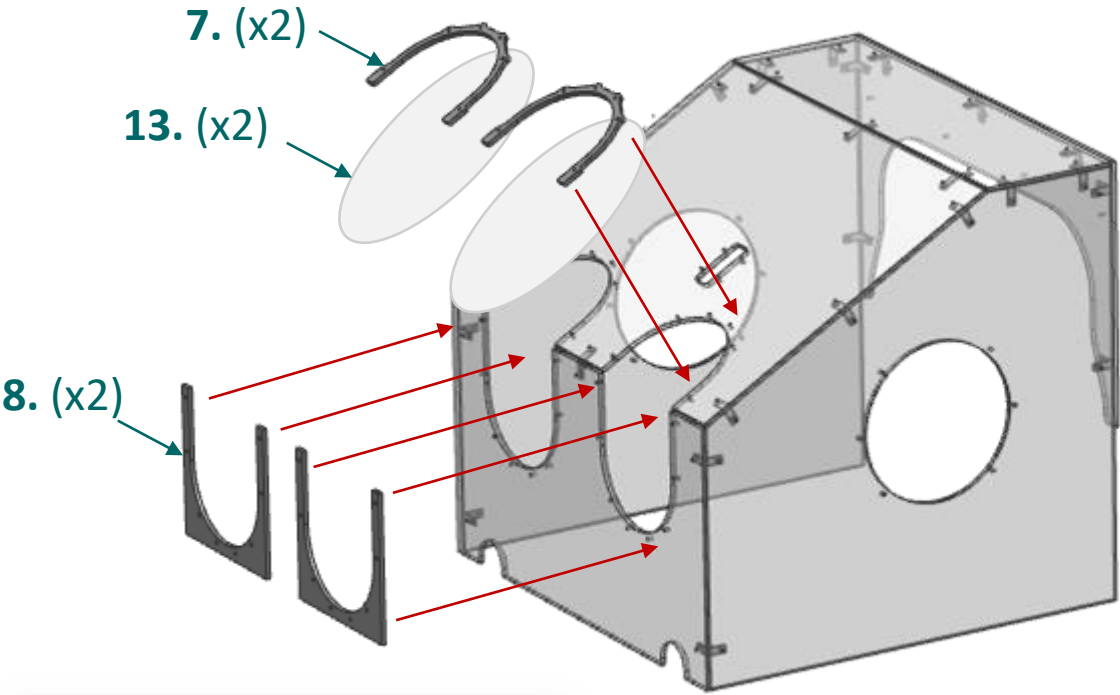

Component		#
Assembly (Step 5)		1
7.	Front Upper Clamp	2
8.	Front Lower Clamp	2
13.	Large Front Port Inserts	4
18.	M4 x 16 button head Bolts	14
20.	M4 Dome Nuts	14

- Mount the 2 large front port inserts to one set of front upper & lower clamps so that the inserts are overlapping. Then inserting the M4 button head Bolts through both parts
- Align the Bolts with the holes on the diagonal panel (assembly) and fix in place with the M4 dome head nuts on the inside
- Torque all bolts on that side to 1Nm or as tight as able without exceeding this value
- Repeat on the 2<sup>nd</sup> front port

*\* Fixings (18. – 20.) not shown for clarity*

Step 7

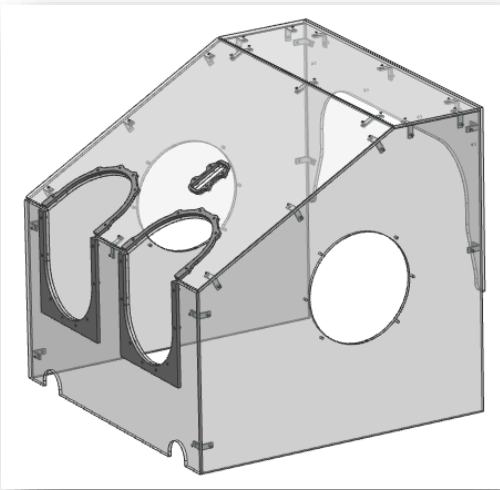
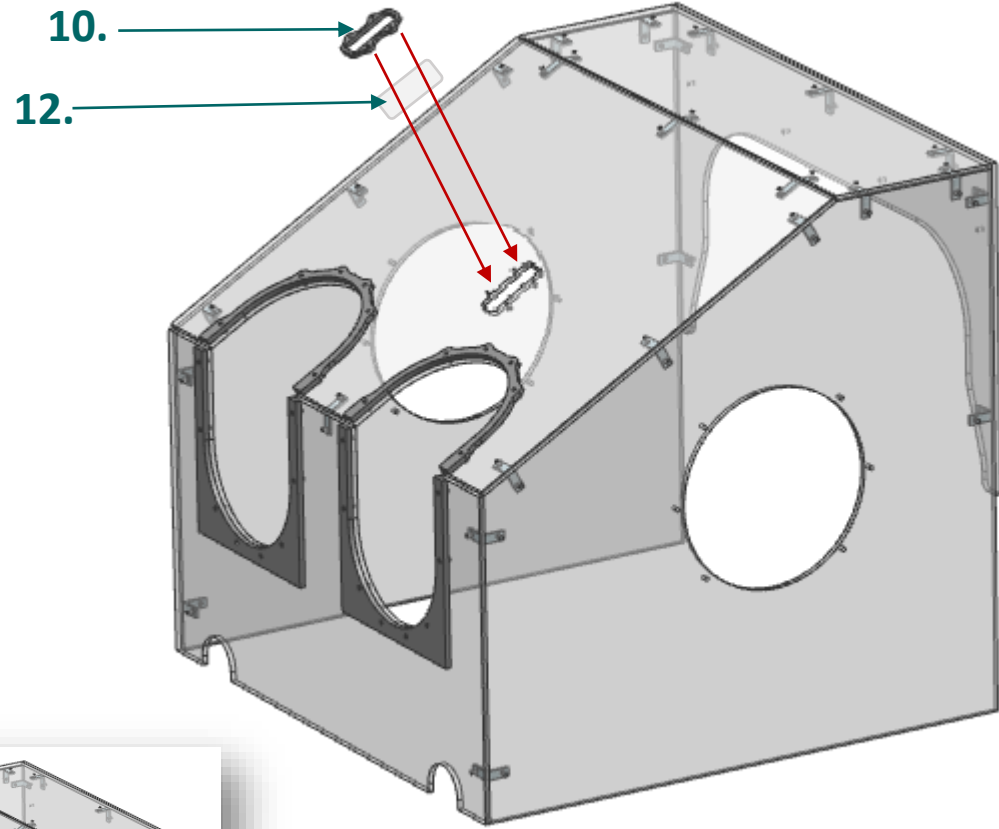

Component		#
Assembly (Step 6)		1
10.	Access Hole Clamp	1
12.	Access hole Insert	1
18.	M4 x 16 button head Bolts	4
20.	M4 Dome Nuts	4

- Mount the Access hole insert to the access hole clamp by inserting the M4 button head Bolts through both
- Align the Bolts with the holes on the diagonal panel (assembly) and fix in place with the M4 dome head nuts on the inside
- Torque all bolts on that side to 1Nm or as tight as able without exceeding this value

*\* Fixings (18. – 20.) not shown for clarity*

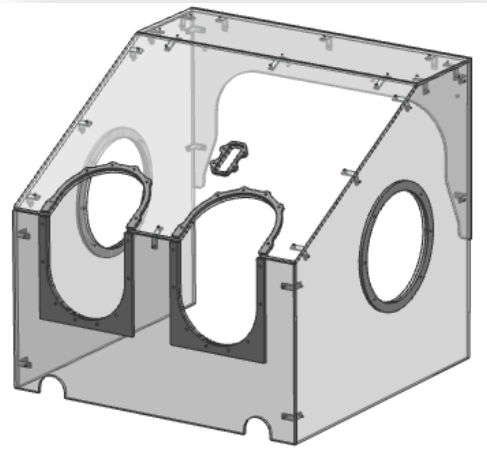
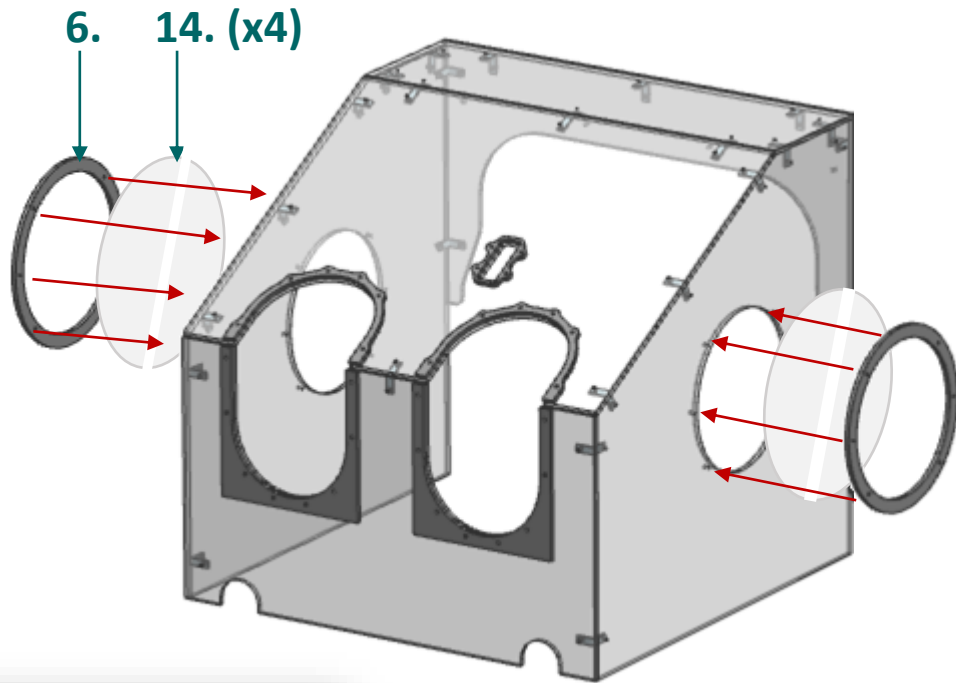

Component	#
Assembly (Step 5)	1
6. Side Clamp	2
14. Small Side Port Inserts	4
18. M4 x 16 button head Bolts	12
20. M4 Dome Nuts	12

- Mount 2 side port inserts to the side clamp so they are overlapping with the slit vertical. Then insert the M4 button head Bolts through both parts
- Align the Bolts with the holes on the side panel panel (assembly) and fix in place with the M4 dome head nuts on the inside
- Torque all bolts on that side to 1Nm or as tight as able without exceeding this value
- Repeat on the 2<sup>nd</sup> side port

*\* Fixings (18. – 20.) not shown for clarity*



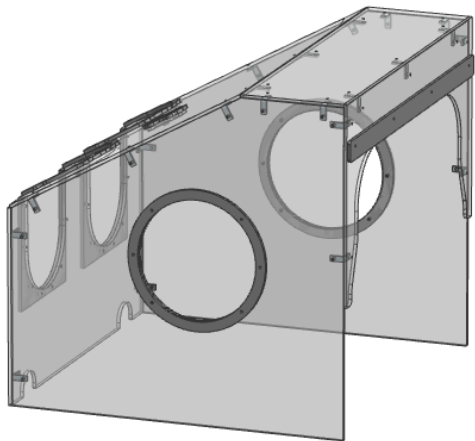
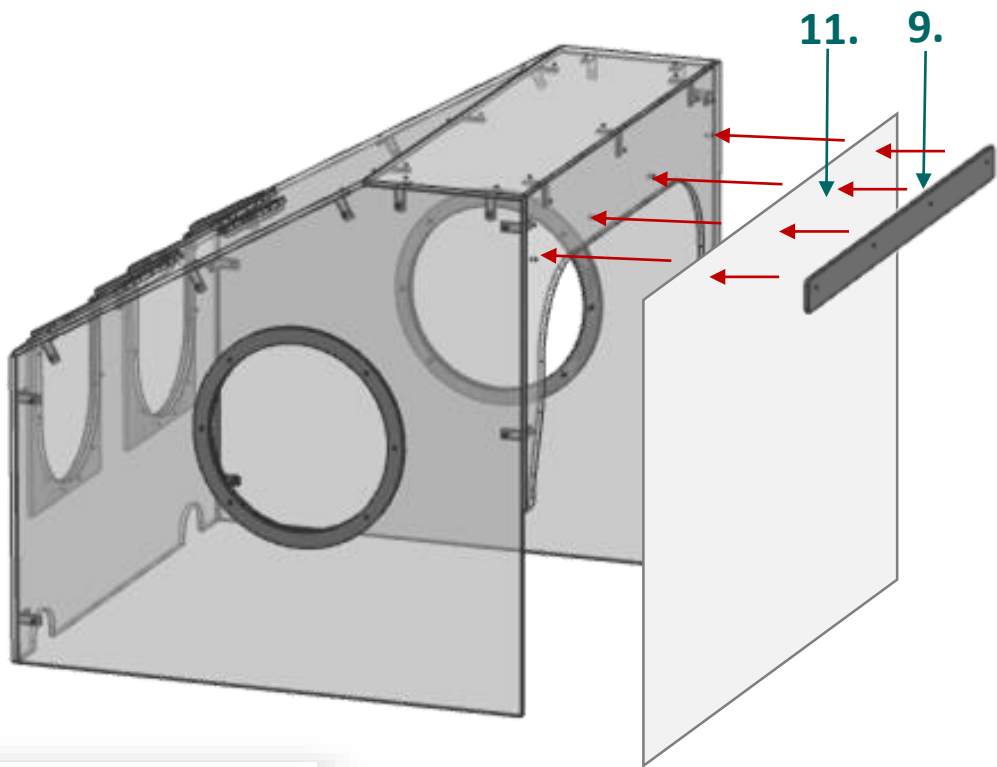

Component	#
Assembly (Step 7)	1
9. Curtain Clamp	1
11. Back Curtain	1
18. M4 x 16 button head Bolts	4
20. M4 Dome Nuts	4

- Mount the Back curtain to the curtain clamp by inserting the M4 button head Bolts through both
- Align the Bolts with the holes on the back panel (assembly) and fix in place with the M4 dome head nuts on the inside
- Torque all bolts on that side to 1Nm or as tight as able without exceeding this value

*\* Fixings (18. – 20.) not shown for clarity*

### Other Assembly / Manufacture methods

- Bracket assembly (as per instructions)
  - Plastic welded joins with no filler material or glue
  - Line bent during manufacture as a single piece
-

## Main Structure / Body (Components 1 – 10)

- Material Thickness - 5mm\*
- Acrylic, PETG, or Polycarbonate\*\*

## Flexible Parts (Components 11 – 14)

- 1.5mm Translucent/Clear Silicone Rubber Sheet

## Fasteners & Brackets (Components 15 – 20)

- 316 or 304 Stainless Steel
- All M4 Button Head Bolts\* - Various lengths
- M4 Dome Nuts\*

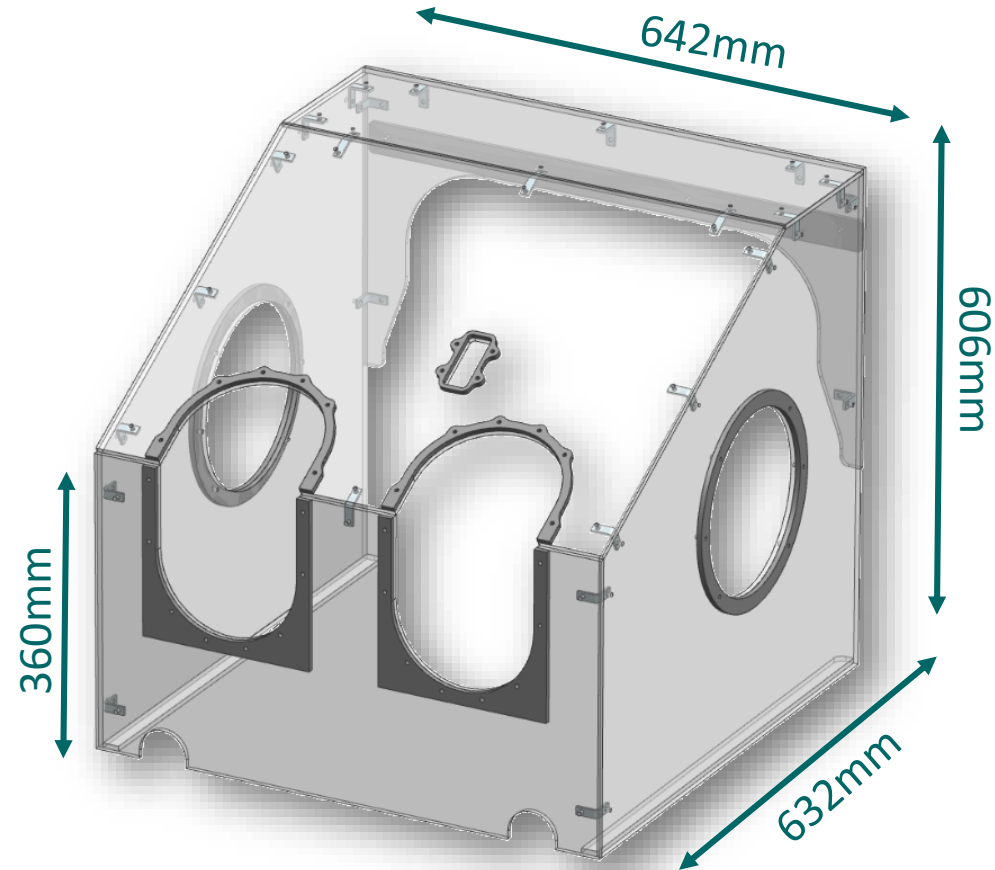

\* Can change if required for supply issues  
\*\* Dependant on manufacturing process and supply chain)

- A. Access for operator during intubation or extubation
- B. Access for boujie\* and endotracheal (breathing) tube to allow proper alignment to patient for placement
- C. Access for anaesthetic assistant to assist with the procedure
- D. Access for body placement and any further procedural access required

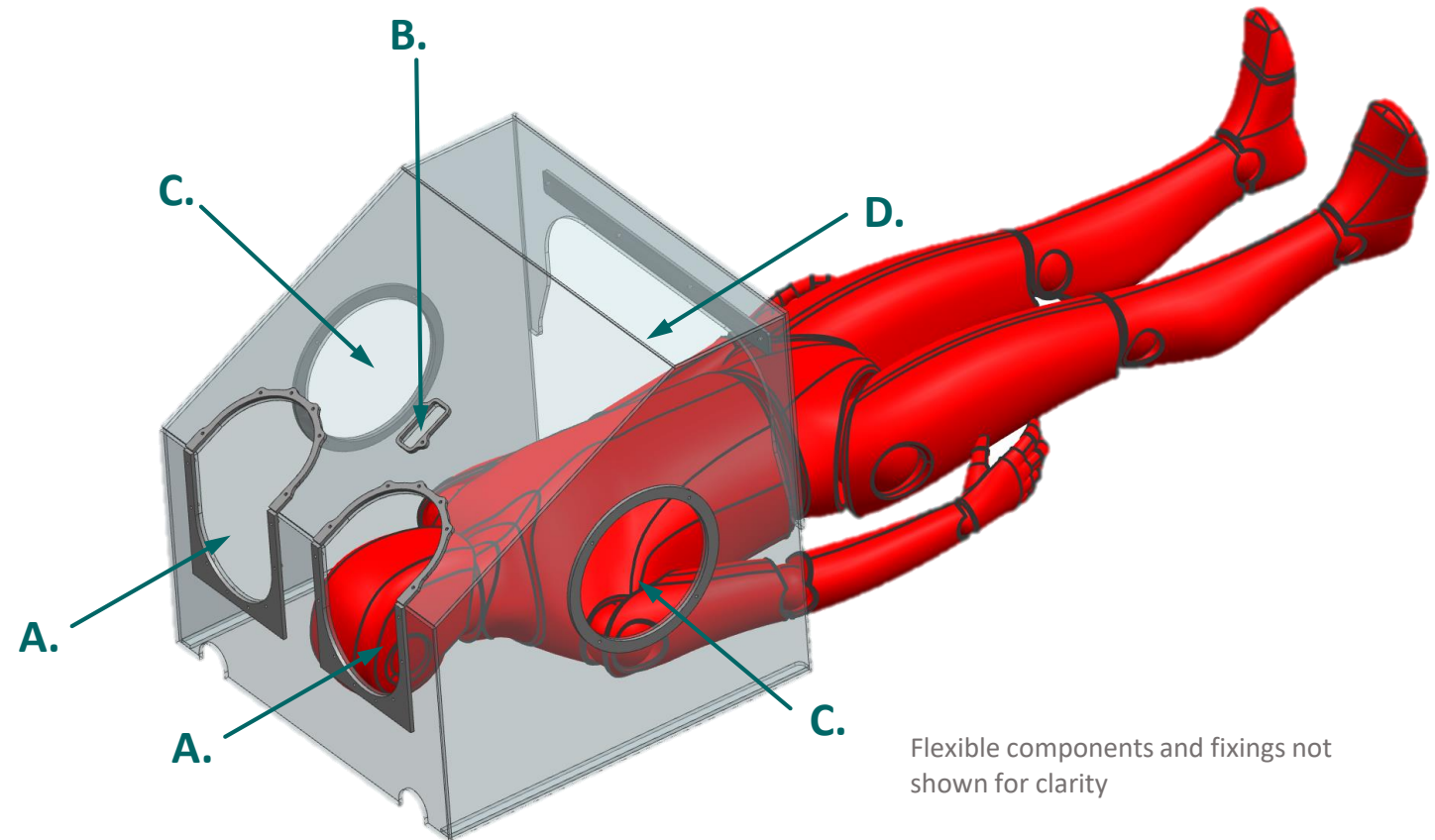

Flexible components and fixings not shown for clarity

\*semi-flexible blue instrument used to aid intubation. Not always required